

# LAKE TAHOE

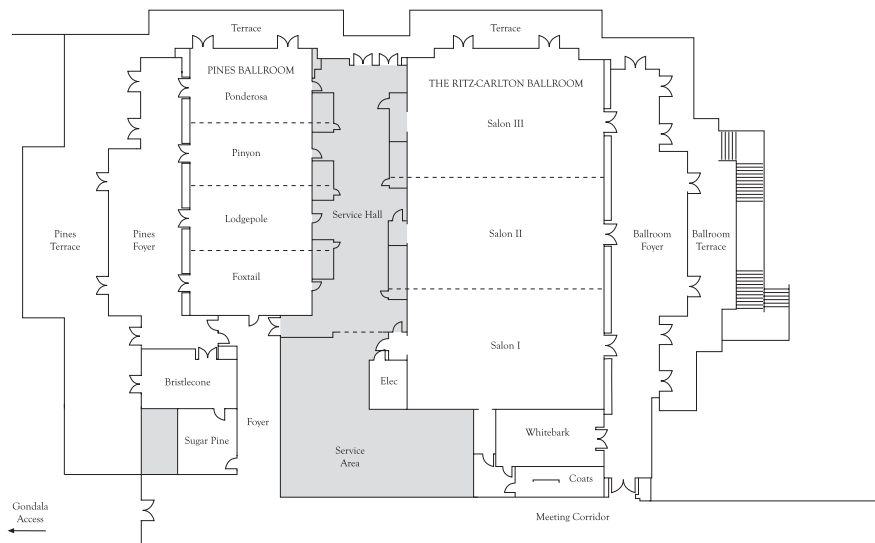

| MEETING SPACE             | Square Feet | Square Meters | Dimensions Feet | Dimensions Meters | Reception | Banquet Rounds of 10 | Theatre Seating | Conference Seating | Classroom Seating | U-Shape Seating |
|---------------------------|-------------|---------------|-----------------|-------------------|-----------|----------------------|-----------------|--------------------|-------------------|-----------------|
| The Ritz-Carlton Ballroom | 6,600       | 613           | 60x110          | 18.3x33.5         | 478       | 400                  | 520             | 193                | 300               | 215             |
| Salon I                   | 2,160       | 201           | 36x60           | 11x18.3           | 157       | 120                  | 170             | 63                 | 108               | 70              |
| Salon II                  | 2,040       | 190           | 34x60           | 10.4x18.3         | 148       | 120                  | 160             | 60                 | 108               | 66              |
| Salon III                 | 2,280       | 212           | 38x60           | 11.6x18.3         | 165       | 130                  | 180             | 67                 | 108               | 74              |
| Ballroom Foyer            | 2,313       | 215           | 27x126          | 8.2x38.4          | 168       | 90                   | 160             | –                  | –                 | –               |
| Ballroom Terrace          | 2,712       | 252           | 24x113          | 7.3x34.4          | 180       | –                    | –               | –                  | –                 | –               |
| Pines Ballroom            | 3,002       | 279           | 38x79           | 11.6x24.1         | 218       | 180                  | 235             | 88                 | 145               | 98              |
| Foxtail                   | 722         | 67            | 19x38           | 5.8x11.6          | 52        | 40                   | 57              | 22                 | 30                | 23              |
| Lodgepole                 | 722         | 67            | 19x38           | 5.8x11.6          | 52        | 40                   | 57              | 22                 | 30                | 23              |
| Pinyon                    | 722         | 67            | 19x38           | 5.8x11.6          | 52        | 40                   | 57              | 22                 | 30                | 23              |
| Ponderosa                 | 836         | 78            | 22x38           | 6.7x11.6          | 61        | 50                   | 66              | 22                 | 45                | 26              |
| Pines Foyer               | 1,803       | 167           | 34x92           | 10.4x28           | 131       | 70                   | 140             | –                  | –                 | –               |
| Pines Terrace             | 2,695       | 250           | 35x112          | 10.7x34.1         | 200       | 130                  | 60              | –                  | –                 | –               |
| Whitebark                 | 544         | 51            | 17x32           | 5.2x9.8           | 39        | 30                   | 43              | 22                 | 26                | 18              |
| Bristlecone               | 464         | 43            | 16x29           | 4.9x8.8           | –         | –                    | –               | 14                 | –                 | –               |
| Sugar Pine                | 240         | 22            | 15x16           | 4.6x4.9           | –         | 10                   | –               | 8                  | –                 | –               |
| The Meadows*              | 6,600       | 613           | 60x110          | 18.3x33.5         | 400       | 400                  | 400             | –                  | –                 | –               |
| The Woods*                | 1,500       | 139           | 30x50           | 9.1x15.2          | 200       | –                    | 200             | –                  | –                 | –               |
| Fireside Terrace*         | 1,733       | 161           | 71x27           | 21.6x8.3          | 180       | 120                  | 180             | –                  | –                 | –               |
| Mountain Blue Terrace*    | 7,371       | 685           | 91x81           | 27.7x24.7         | 300       | 210                  | –               | –                  | –                 | –               |

\*Outdoor venues

13031 Ritz-Carlton Highlands Court • Truckee, California 96161 • USA

TEL 530-562-3000 SALES FAX 530-562-3024

[www.ritzcarlton.com/laketahoe](http://www.ritzcarlton.com/laketahoe)

